

# NEW NEIGHBOR CARE GROUP

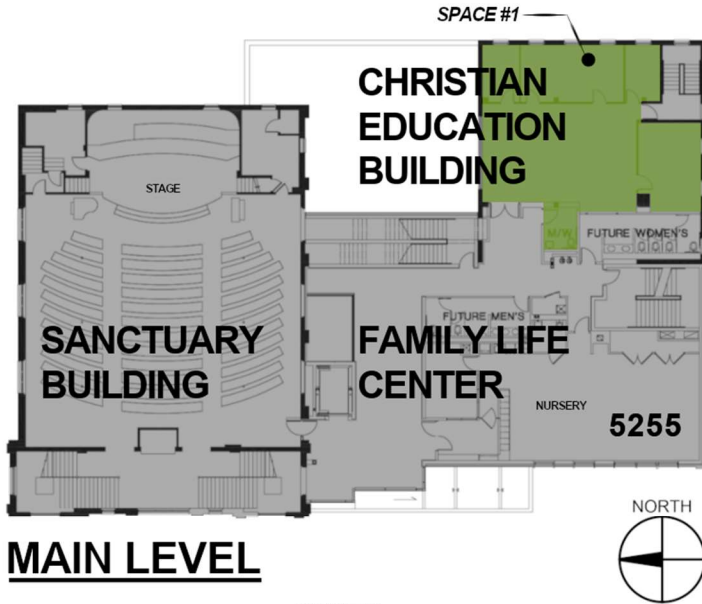

Potential Temporary Housing Options (for roughly 8 to 12 months):

- ~\$900 / month for a family of four (~\$14K for a family of 5, not included in the budgets below)
- Family placed with us through Faith Community Initiative (“FCI”)
- FCI mission to place families needing shelter with local churches for temporary housing
- Some funding potentially available through FCI and their network
- Learn more about the great work that the Faith Community Initiative is doing here: <https://www.faithcommunityinitiative.org/>

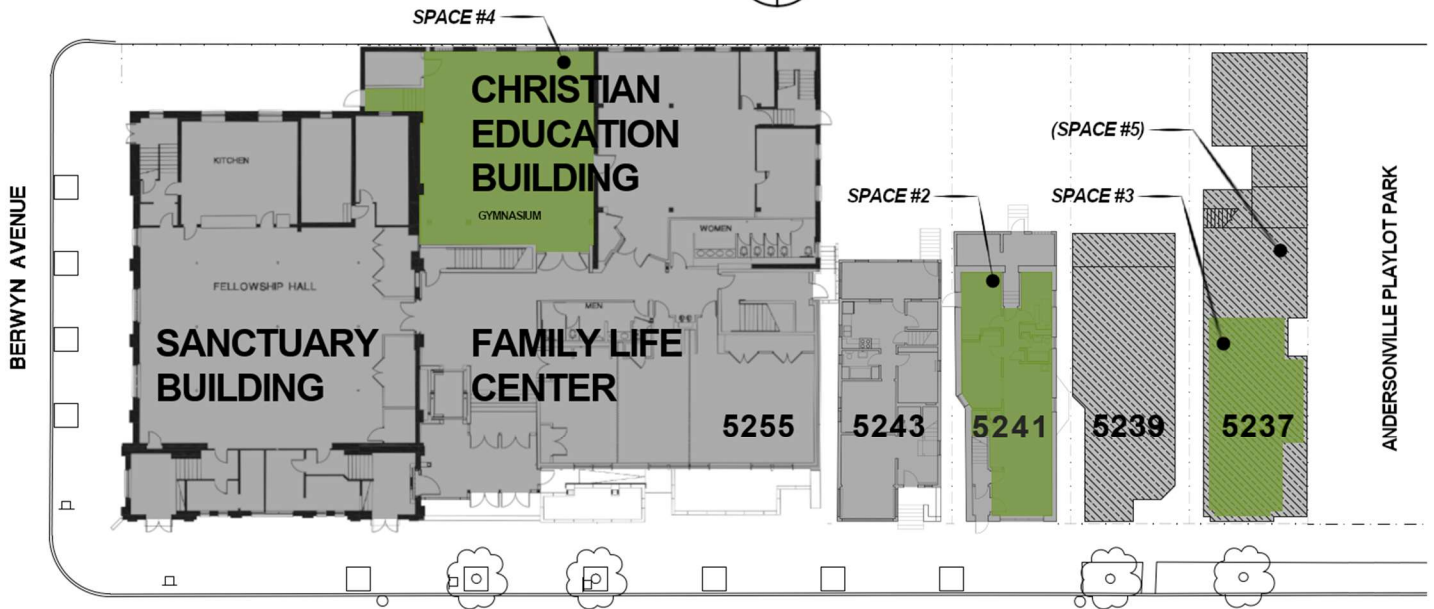

## LOWER LEVEL

ASHLAND AVENUE

## GROUND LEVEL

Space	Location	Amenities / Needs	Family Config.	Work Needed	Budget	Move-in
#1	2 <sup>nd</sup> Floor C.E. (“Old K-5 room”)	K-5 rooms, 2 <sup>nd</sup> floor FLC hallway bath, Fellowship Hall Kitchen & Office Building shower	Family of 4 + extended relatives or 2 smaller families	Re-keying, moving items into storage, touch-up painting	~\$3K [+optional \$15K convert storage into bathrooms]	2 to 4 weeks [+ 1 – 2 months]
#2	1 <sup>st</sup> Floor Office Building	Slightly renovated 1 <sup>st</sup> Floor 5241 Office Building apartment	Family of 4 to 6	New kitchenette + Re-keying, moving items into storage, touch-up painting	~\$13K	1 month
#3	Garden Unit of 5237	Converted Garden Unit 5237 Apartment (next to playlot)	Family of 4 or 5	Localized brick-work, apartment build-out	~\$120K	9 to 12 months +
#4	Gymnasium	Gymnasium + Fellowship Hall kitchen (?)	Individuals / families overnight	Move items into storage	~0 (need to identify subsidy)	1 week
#5	Existing 5237 Apartments	Any of one the existing 5237 apartments	Family of 4 to 6	Re-keying, touch-up painting	~\$3K	[None]